

THE SHARED UNIVERSE VENTURES NEWSLETTER AUGUST/SEPTEMBER 2015



“BE PART OF THE
JOURNEY,
BE PART OF THE
SOLUTION”

THE SHARED UNIVERSE VENTURES ROADSHOW

One evening around the fire in our beautiful lapa at Mopane Bush Lodge a few shareholders decided to do an international roadshow, to introduce new prospective investors and interested parties to the opportunities to make a difference and help saving our endangered rhinos of Africa.

In early September, with much enthusiasm we set-up a presentation evening in London, Amsterdam and Zurich. Friends were selected and invited to an informal meeting where we shared wine, South African biltong and of course the story of our beloved rhinos.

Between Toine, Quinten, Gaby, Rene and myself we shared our passion and why we are doing what we are doing in Africa. We talked about the plight of the rhino but also about other endangered species and why it is our responsibility as guardians to take care of our wildlife. We debated and answered questions. People got enthusiastic and a few decided to join us on this incredible

journey. We have made new friends to share the project with. With our increasing numbers we are growing stronger.

This journey is not for the fainthearted nor for the person who likes safety and conformity. This voyage is meant for the bold, the risk takers, and the ones that leads from the front. This journey is a special experience of making a real difference in guardianship of our irreplaceable wildlife.

A very warm welcome to all our new shareholders, guardians and sponsors. Let's drive this project and make it even better and more successful than what we could ever have imagined.

We look forward to hosting you in Africa at our piece of heaven, Mopane Bush Lodge.

See you soon.

- Rudi

SUMMARY

- LESSONS FROM NATURE
- FUNDRAISING WRITE-UP SHARE UNIVERSE
- FOUNDATION IS NOW FORMED
- CONSTRUCTION OF A RHINO ORPHANAGE
- SOUTH AFRICA'S FIRST RHINO AMBULANCE
- AMMADO DONATION PAYMENT SYSTEM
- WHO'S WHO IN SHARED UNIVERSE VENTURES?



LESSONS FROM NATURE

Well Grounded – Trees have extensive root systems.

Roots are the foundation of a healthy plant. The condition of a plant's root system has a profound effect on its overall health. While plants can tolerate a fair amount of damage to their upper parts, they are not nearly so forgiving of damage to their roots. **It's important to have a culture that is solidly embedded in ethical and other principles.** If the organization is to survive, leadership needs to be grounded in deep principles that provide valuable guidance especially when there is a dilemma faced in the decision making process.

.....



FUNDRAISING WRITE-UP

The Moon shone brightly on the Shared Universe Foundation fundraising dinner on 29 August 2015 held in Magoebaskloof, Tzaneen.

Shared Universe Foundation in conjunction with Rotary E-Club and Warriors Rotaract Club, hosted a fundraising dinner and auction in support of the rhino orphanage and outfitting South Africa's first rhino ambulance.

A keynote address was delivered by Professor Wouter van Hoven who shared a powerful message on the future of the species and insight into how we can help save these majestic animals.



Prof. Wouter van Hoven

He confirmed the need for more rhino orphanages and discussed how a rhino ambulance can help save rhinos all over South Africa.

Thank you to all our guests who attended the dinner, contributed in the auction and made this worthwhile fundraiser a huge success.





SHARE UNIVERSE FOUNDATION IS NOW FORMED

Shared Universe Foundation is a registered non-profit Foundation under the laws of South Africa.

It accepts charitable donations of which 100% of the contributions are used for the protection and salvation of endangered rhinos and other species.

Various projects are being developed such as:

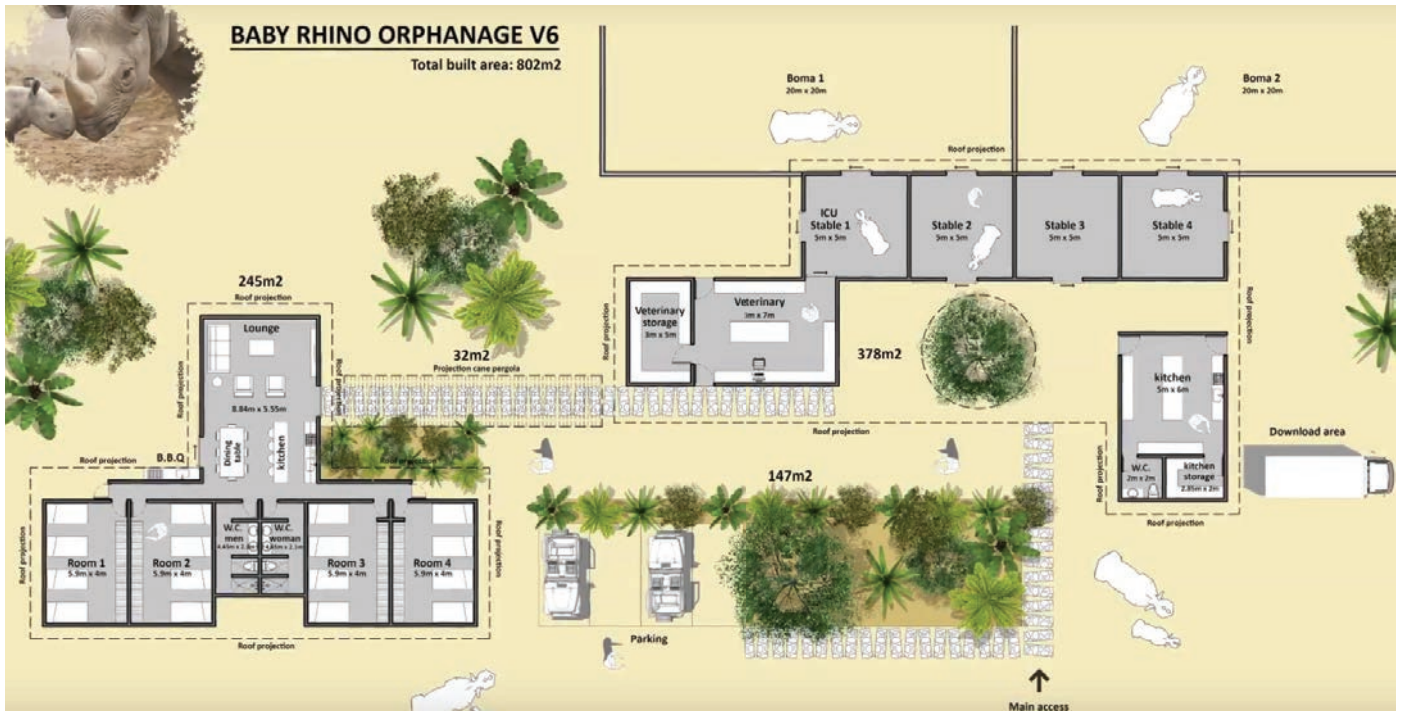

CONSTRUCTION OF A RHINO ORPHANAGE

- The orphanage will accommodate both orphaned baby rhinos and or injured rhinos
- The facility will provide these rhinos with all the necessary care and nutrition to grow up in good health
- Will provide the proper facilities and accommodations for volunteers and medical staff who work with the rhinos
- It will serve to help with educating the public on rhino poaching and demystifying the medical qualities of rhino horn
- It will be a guarded safe haven rhinos

SOUTH AFRICA'S FIRST RHINO AMBULANCE

Sponsors are being sought after for the first ever ambulance dedicated to the sole purpose of transportation of injured or orphaned rhinos and other animals. This truck/ambulance needs specialized equipment to help facilitate in the role. Items such as strengthened chassis, hydraulic leg supports, double folding lifting ramp, roll bar with roof rack, etc. all necessities in ensure the safety, accessibility and security for all involved.



AMMADO DONATION PAYMENT SYSTEM

Now being implemented is the new donation system with Ammado. Ammado, awarded the Innovation Award in 2011, allows charitable donations to be processed in 84 different currencies for all sorts of non-profit organizations. We have added their button on the SUF's website and Facebook account and plan to utilize them for the various events and fundraisers as needed.



The screenshot shows the 'Make a Donation' interface for The Shared Universe Foundation. It includes a header with the foundation's name and a small image of a rhinoceros. The main text describes the foundation's focus on rhinoceros conservation and awareness in South Africa. Below this, there are fields for 'Amount' (set to € 0.00) and 'Pay using' (with a 'Select method' button). There are also radio buttons for 'Single donation' (selected) and 'Repeat every month'. An 'Options' section allows for anonymous donations or adding a message. A large 'DONATE NOW' button is at the bottom, with the Ammado logo and 'The Shared Universe Foundation' text below it.

Come visit the NEW website for more information at www.shareduniversefoundation.org and share it with people you know! Let's continue to spread the word.

WHO'S WHO IN SHARED UNIVERSE VENTURES?



RUDI VILJOEN
Trustee, Board Member



TOINE KNIPPING
Trustee, Board Member



BRIAN DAWSON
Trustee



PETER DE LUCA
Trustee



JAN TROMP
Trustee



QUINTEN KNIPPING
Board Member